

1

2

3

4

A

B

C

D

E

F

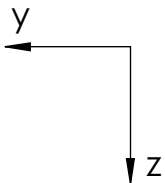
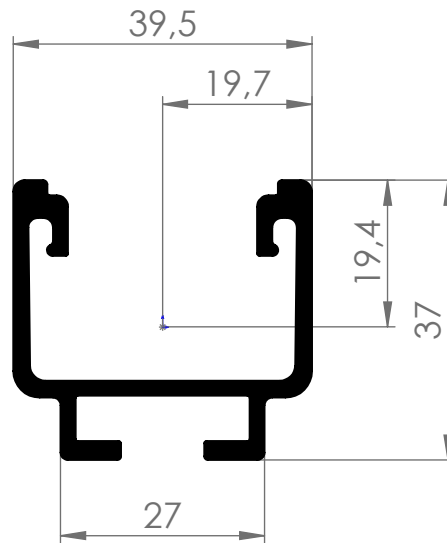

## Characteristics for calculation:

$$A = 3,15 \text{ cm}^2$$

$$I_y = 4,36 \text{ cm}^4$$

$$I_z = 6,98 \text{ cm}^4$$

$$W_y = 2,25 \text{ cm}^3$$

$$W_z = 3,54 \text{ cm}^3$$



K2 Systems GmbH  
Industriestr. 18  
71272 Renningen  
07159/42059-0

Designation:

Data sheet  
SolidRail Light per meter

Name	Date	Material:	Item no.:	A4
Designed	K. Mahboobi	12.09.2019	EN AW 6063 T66	2002293
Approved	A. Soumpalas	03.02.2023	Surface: mill finish	Drawing no.: 01-001-11
Last change	E. Markou	31.01.2023	Weight: ca. 850,2 g/m	Scale: 1:1
			All dimensions in mm	
			Sheet 1 of 2	

This drawing is the sole property of K2 Systems GmbH. It is protected by copyright and may only be copied, reproduced or distributed to a third party with explicit permission!